

PROPOSED SITE PLAN FOR HEALTHCARE HUB AND MUSICAL FOUNTAIN & MULTI MEDIA SHOW  
POCKET-E MADHUBAN BAPUDHAM YOJNA; GZB.

HEALTH CARE HUB AREA - 30484.50 SQ.M.

MUSICAL FOUNTAIN AND MULTIMEDIA SHOW AREA - 3000.00 SQ.M.

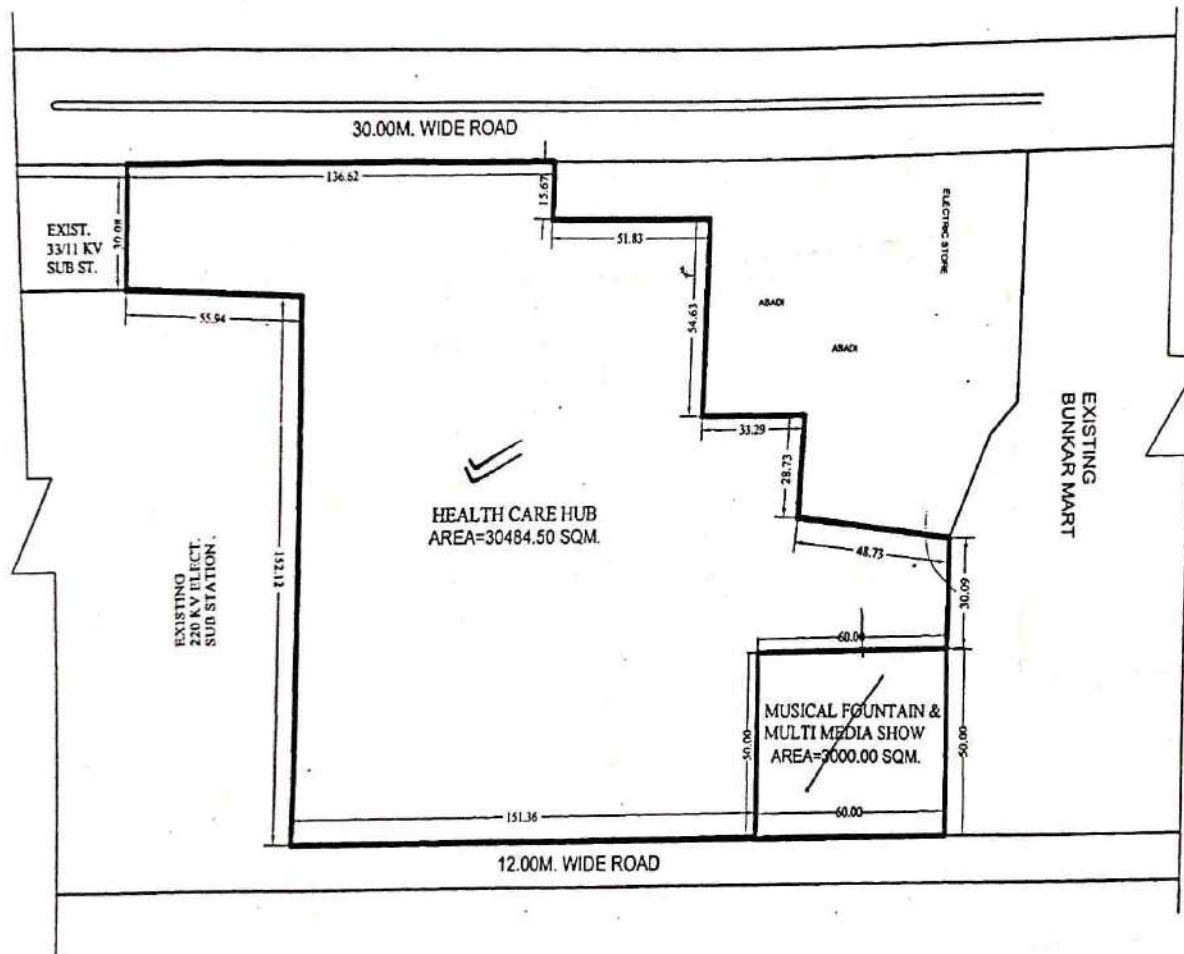

*Amr*  
16-11-19  
D/Man AMIN

*Suloch*  
19-11-19  
J.E.

*[Signature]*  
A.E. E.E.

*[Signature]*  
OSD/5-2-31  
T.P.(R)

*[Signature]*  
T.P.(R)

*[Signature]*  
T.B.(K)

*[Signature]*  
SECRETARY

*[Signature]*  
VICE CHAIRMAN

# REVISED SITE PLAN OF HS-2 AT KOYAL ENCLAVE SCHEME, LONI, GHAZIABAD

## AREA SCHEDULE

HIGHER SECONDRY-2 (H/S-2)	= 6395.00 Sqmt.
GROUND COVERAGE	= 30 %
PERMISSIBLE F.A.R.	= 1.00

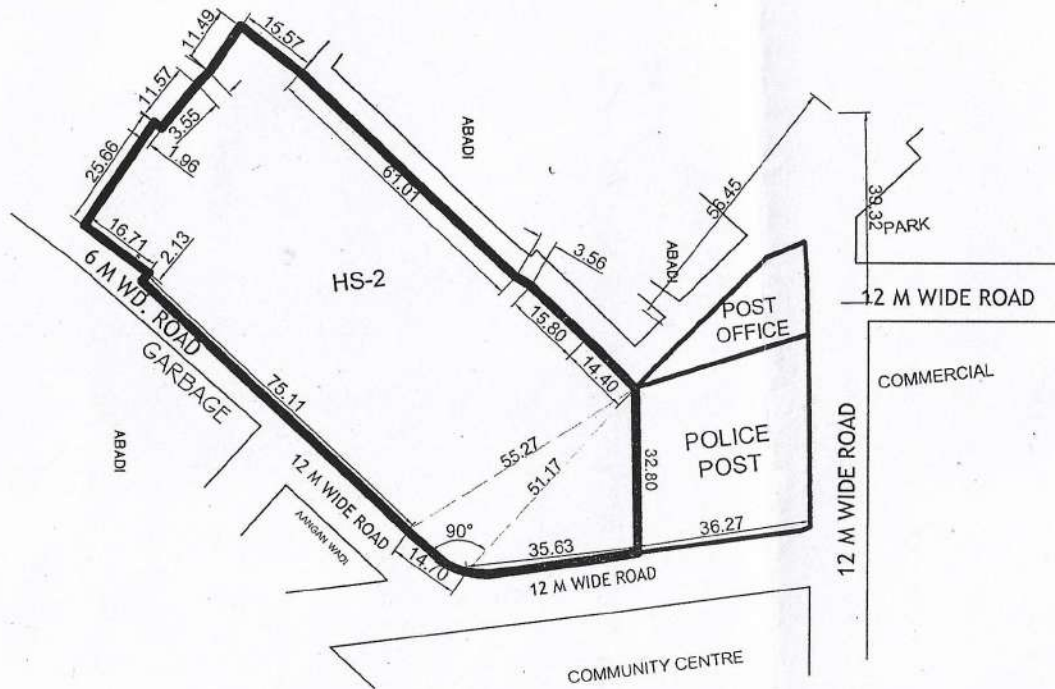

lan

JUN. ENGR.  
27/11/2020

ASTT. ENGR.  
27.11.20

S. ENGR.

T. P. (R)

T. P. (K)

SECRETARY

SECRETARY







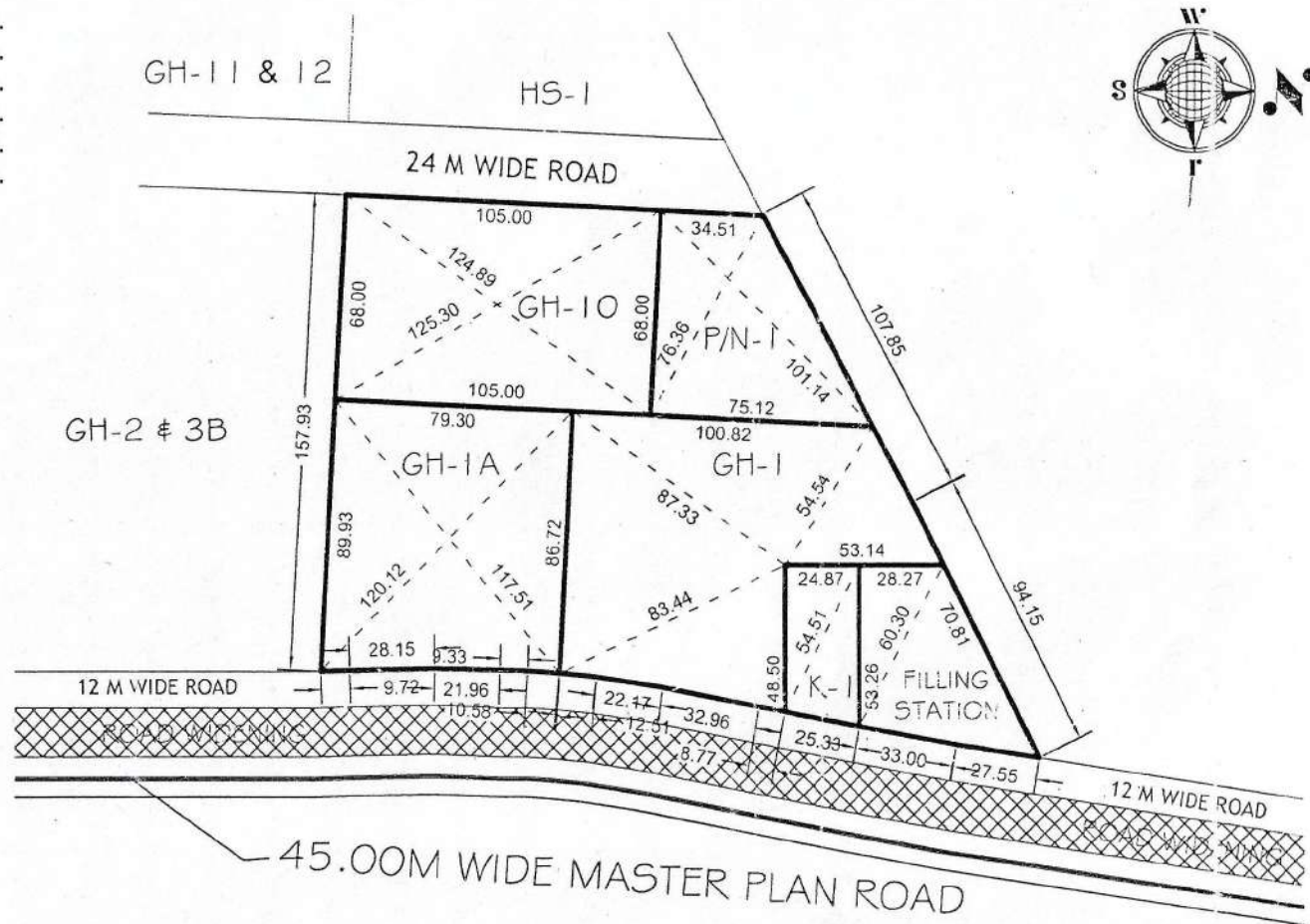

VICE CHAIRMAN

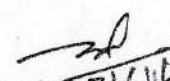
# SITE PLAN OF RESIDENTIAL PLOT No. - K-1, GROUP HOUSING (GH) No. - 1, 1A & 10, PRIMARY / NURSURY (P/N) No. - 1 & FILLING STATION AT KOYAL ENCLAVE SCHEME, LONI, GHAZIABAD

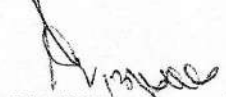
## AREA SCHEDULE

RESIDENTIAL PLOT No.K-1	= 1265.00 Sqm.
FILLING STATION	= 2500.00 Sqm.
GROUP HOUSING (G.H.) No.-1	= 8565.00 Sqm.
GROUP HOUSING (G.H.) No.-1A	= 6958.00 Sqm.
GROUP HOUSING (G.H.) No.-10	= 7140.00 Sqm.
PRIMARY / NURSURY (P/N) No.-1	= 3726.00 Sqm.









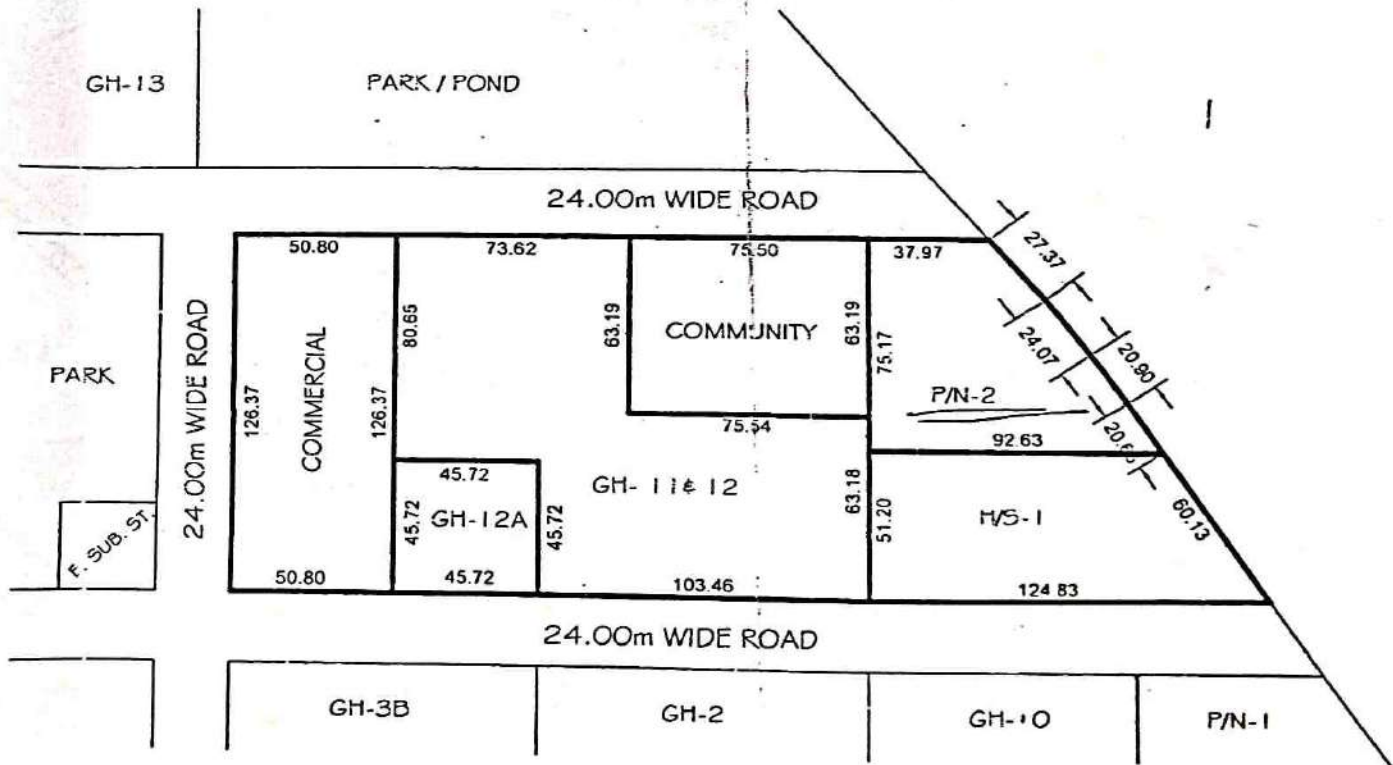

 NITIN KUMAR D/Man	 ANAND SWAMINATHAN AMIN	 R. K. KAUSHIK JUNIOR ENGINEER	 NARENDRA KUMAR ASSISTANT ENGINEER	 R. K. JAINWAL EXECUTIVE ENGINEER	 RAJKUMAR MITTAL TEHSILDAR (L.A.)	 JYOTI PRASAD TOWN PLANNER	 ISTIYAD AHMED C.A.T.B.	 RAVINDRA GODBOLE SECRETARY	 VIJAY KUMAR GOYAL VICE CHAIRMAN
---	--	---	---	---	--	---	--	--	---

# PLAN OF COMMERCIAL PLOT, GROUP HOUSING (GH) No. - 11 & 12, 12A, PRIMARY / NURSURY (P/N) No. - 2, HIGHER SECONDRY (H.S.) -1, COMMUNITY AT KOYAL ENCLAVE SCHEME, LONI, GHAZIABAD

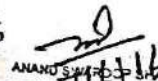
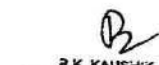
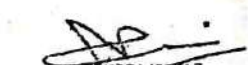
## AREA SCHEDULE

COMMERCIAL PLOT	= 6417.02 Sqm.
GROUP HOUSING (G.H.) No.-12A	= 2090.00 Sqm.
GROUP HOUSING (G.H.) No.-11 & 12	= 11915.26 Sqm.
COMMUNITY	= 4772.00 Sqm.
PRIMARY / NURSURY (P/N) No.-2	= 5011.00 Sqm.
HIGHER SECONDRY (H/S) No.-1	= 5547.00 Sqm.

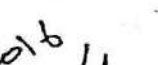

 06/16  
 NITIN KUMAR  
 D/Man  
  
 ANAND KUMAR  
 TANNIN  
  
 R.K. KAUSHIK  
 JUNIOR ENGINEER  
  
 NARENDRA KUMAR  
 ASSISTANT ENGINEER  
  
 S.K. MISHRA  
 EXECUTIVE ENGINEER  
  
 RAJKUMAR MITTAL  
 TEHSILDAR (L.A.)  
  
 23/6/16  
 JYOTI PRASAD  
 TOWN PLANNER  
  
 25/6/2016  
 ISTIYAS AHMED  
 C.A.P.  
  
 RAVINDRA GODBOLE  
 SECRETARY  
  
 V.L. KUMAR GOVAL  
 VICE CHAIRMAN

# SITE PLAN OF POLICE CHOWKI PLOT, COMMUNITY CENTER PLOT & PRI. SCHOOL PLOT AT POCKET-B MADHUBAN BAPUDHAM YOJNA , GDA, GZB.

PRI. SCHOOL PLOT - B/P.S.-1 = 1567.68 SQ.M. ✓  
 COMM. CENTER PLOT - B/C.C.-1 = 2832.56 SQ.M.  
 POLICE CHOWKI PLOT - B/P.C.-1 = 3098.30 SQ.M.

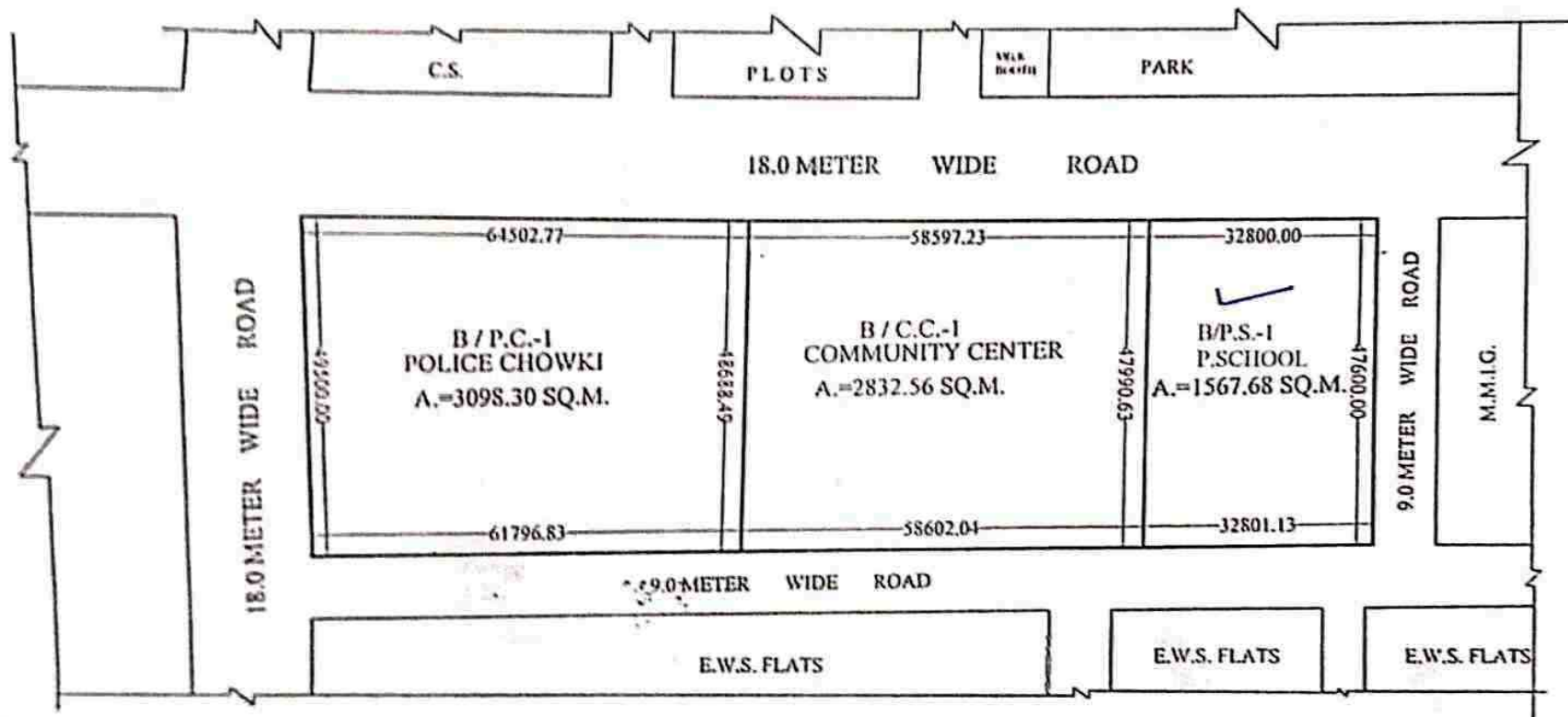

*Admani*  
11-02-21  
PREPARED BY.

*Arund*  
25/02/21  
COMPARED BY.

*[Signature]*  
MEAS.&AREA CAL.(J.E.)

*[Signature]*  
A.E.

*[Signature]*  
E.E.

*[Signature]*  
TOWN PLANNER

PLAN OF PRIMARY SCHOOL PLOT NO. D/P.S.-1 AT POCKET 'D' MADHUBAN BAPUDHAM YOJNA; GZB.  
AREA OF PRI. SCHOOL D/P.S.-1= 1375.00 SQ.M.

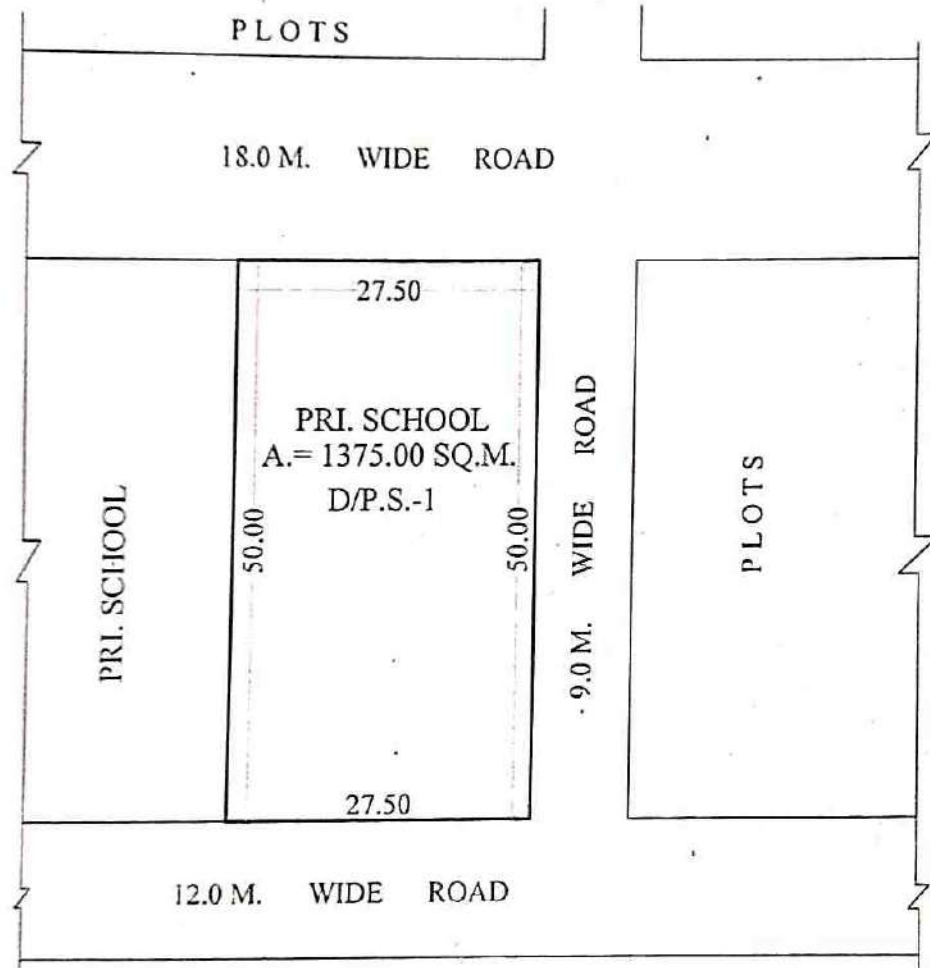

*Hawai*  
06-01-2021  
PREPARED BY

*[Signature]*  
06/01/21  
COMPARED BY

*[Signature]*  
(MEAS. & AREA CAL.) J.E.

*[Signature]*  
A.E.

*[Signature]*  
E.E.

*[Signature]*  
T.P.

PROPOSED SITE FOR NURSING HOSTEL PLOT NO. E/N.HS.-1 IN POCKET-E, AT MADHUBAN BAPUDHAM YOJNA G.D.A. GZB.

AREA OF NURSING HOSTEL PLOT NO. E/N.HS.-1 = 10408.59 SQ.M.

S.No - 14

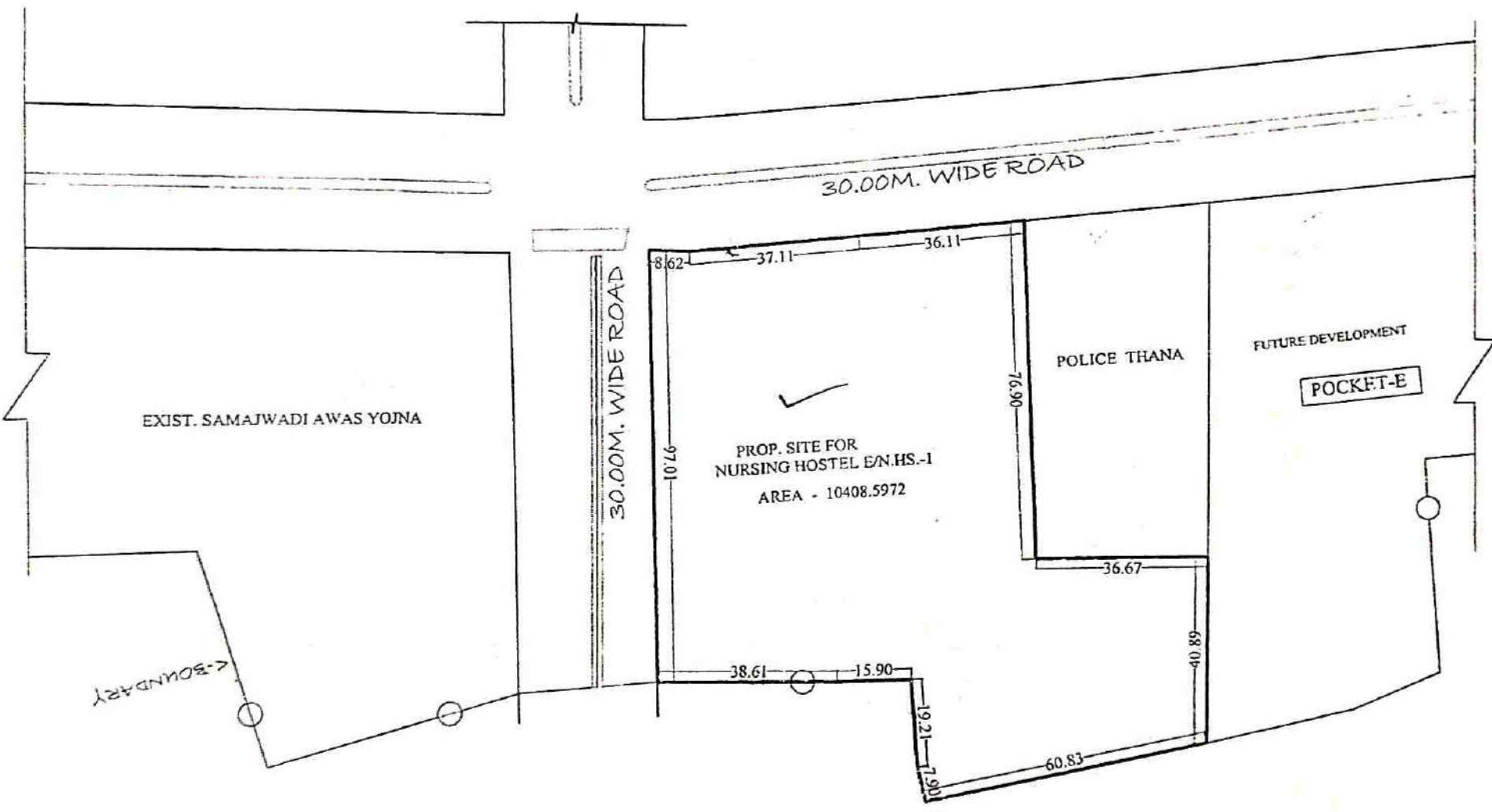

Tentative Site Plan

10/08/2020  
AMIN

JE

OSD-LA

OSD-LA

EF

TP(R)

TP(K)

SECRETARY

VICE CHAIRMAN

**SITE PLAN OF HIGH SCHOOL PLOT CONVERT IN TO G.H / RESI.PLOT/POST OFFICE AT SECTER-3 VAISHALI GHAZIABAD**

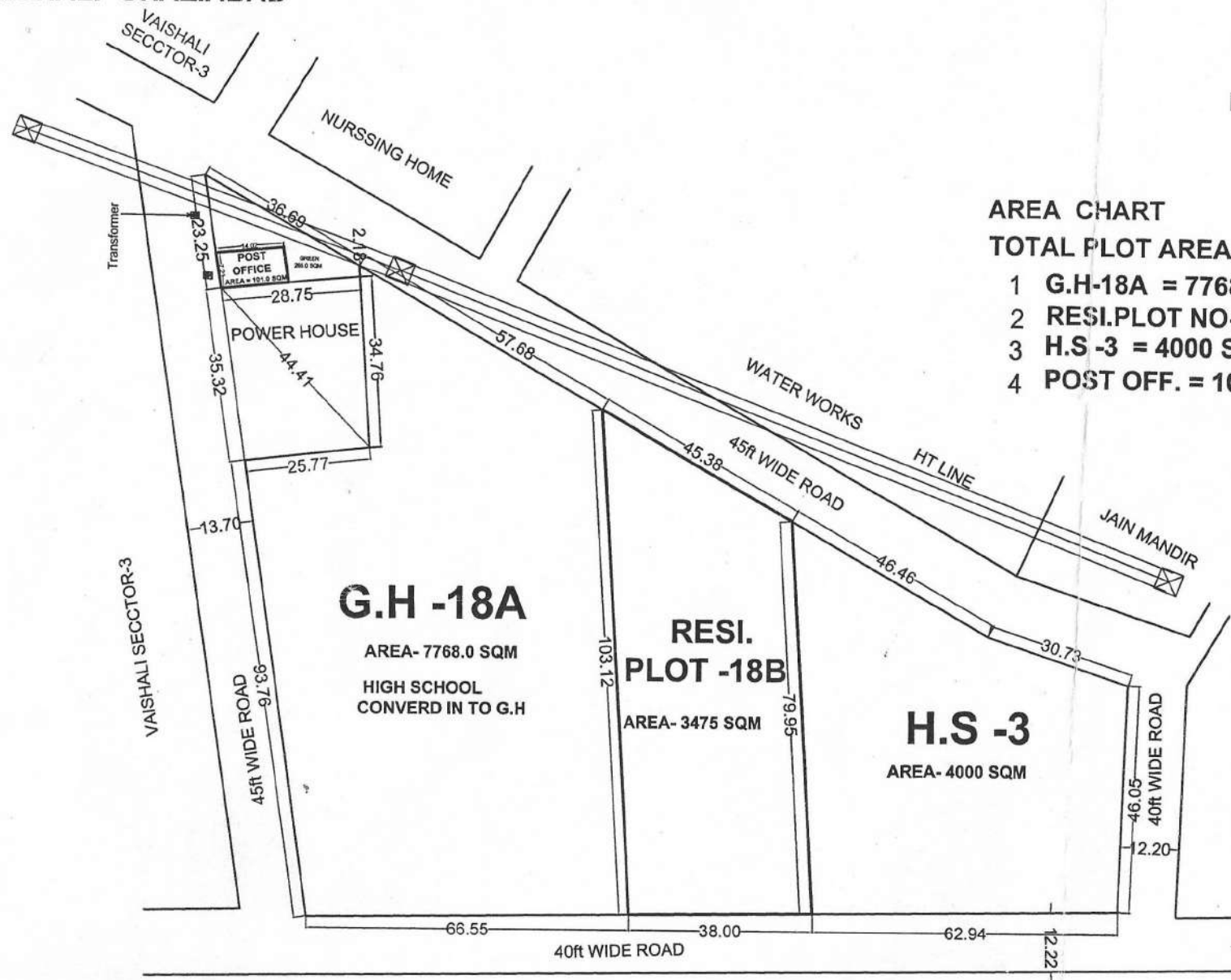

**AREA CHART**

**TOTAL PLOT AREA-15241 SQM**

- 1 G.H-18A = 7768.0 SQM
- 2 RESI.PLOT NO-18B = 3475 SQM
- 3 H.S -3 = 4000 SQM
- 4 POST OFF. = 101.0 SQM

**G.H -18A**

AREA- 7768.0 SQM  
HIGH SCHOOL  
CONVERT IN TO G.H

**RESI.  
PLOT -18B**

AREA- 3475 SQM

**H.S -3**

AREA- 4000 SQM

*[Signature]*  
21/10/16  
D/M.

*[Signature]*  
T.P.

*[Signature]*  
C.A.T.P

*[Signature]*  
21/10/16  
SECY.

*[Signature]*  
V.C



# REVISED SITE PLAN FOR COMMUNITY CENTER & NURSING HOME AT SECTER-3 VAISHALI, GHAZIABAD

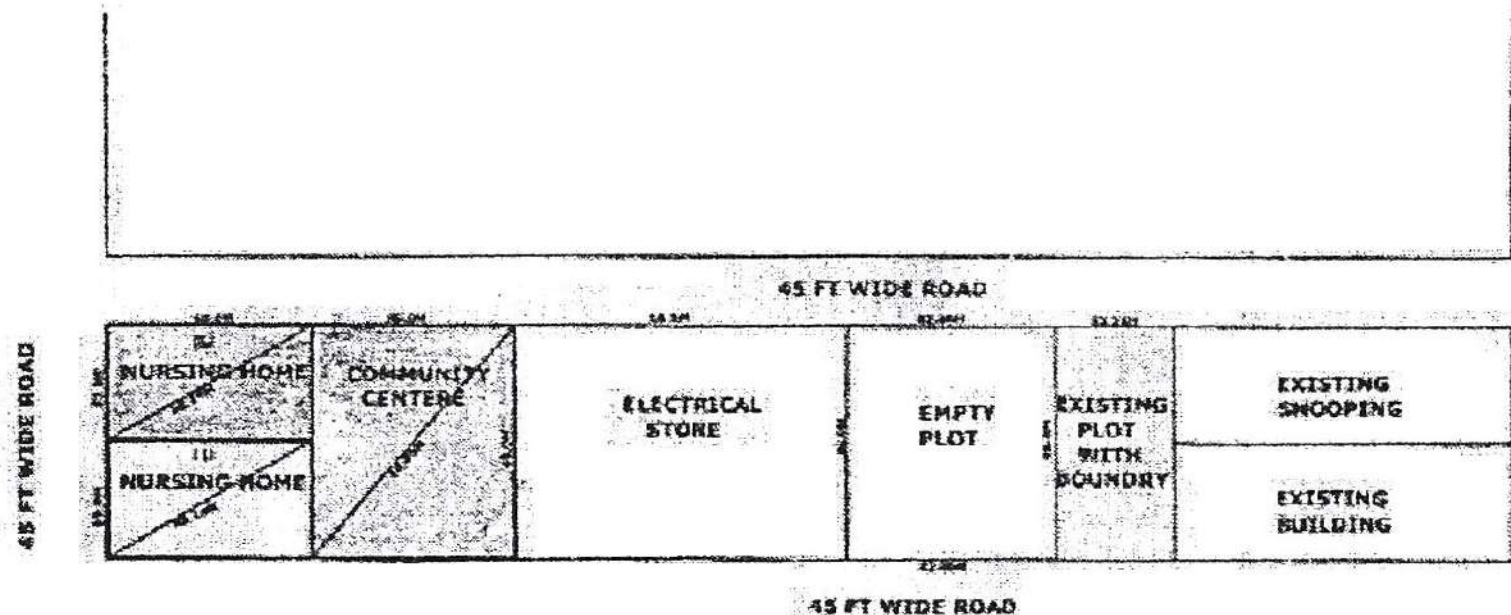

NURSING HOME NO- 1	AREA	40.0M X 23.0M	=	920 S.Q.M
NURSING HOME NO- 2	AREA	40.0M X 23.0M	=	920 S.Q.M
COMMUNITY CENTER	AREA	40.00M X 46.0M	=	1840 S.Q. M

*[Signature]*  
D/M

*[Signature]*  
AMIN

*[Signature]*  
J.E

*[Signature]*  
A.E

E.E-6

TEH (LA)

*[Signature]*  
Y.B

*[Signature]*  
SHT P

*[Signature]*  
SECRETARY

*[Signature]*

# PROPOSED PART LAYOUT PLAN AT SECTOR VI VAISHALI

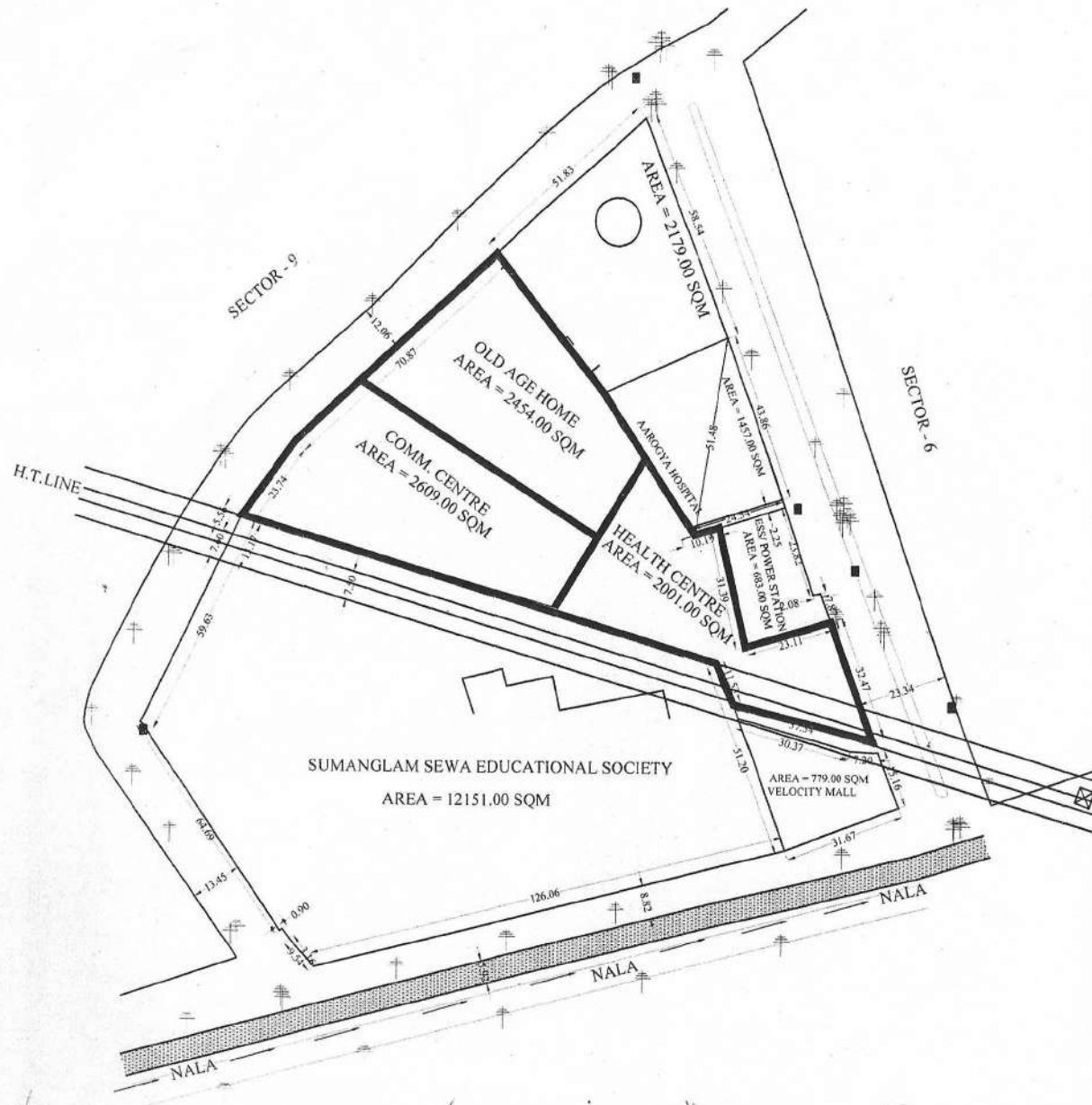

*[Signature]*  
D/MAN

*[Signature]*  
J.E.

*[Signature]*  
A.E.

*[Signature]*  
E.E.

*[Signature]*  
T.P.

*[Signature]*  
C.A.T.P.

S